





Studio Pulse 2

Home Entertainment Soundbar

- 

DSP
Azatom
Signature Sound
- 

Bluetooth
Audio
- 

TOSLINK
Optical Audio
- 

Full Range
Drivers
- 

AUX IN
- 

Equaliser
- 

Remote Control
- 

120
Watt
MAX Power





AZATOM
NEXT GENERATION SOUND



Contents

1. Important Safety Instructions	3
1.1 Safety.....	3
1.2 Warning.....	4
2. Package Contents	5
3. Identifying the Parts.....	6
3.1 Soundbar.....	6
3.2 Remote Control.....	7
4. Placement and Mounting	8
4.1 Placement.....	8
4.2 Wall Mounting	8
5. Connections.....	9
5.1 Use the OPTICAL Socket.....	9
5.2 Use the AUX Socket.....	9
5.3 Connect Power	9
6. Basic Operation	9
6.1 Standby/ON.....	9
6.2 Select Modes.....	9
6.3 Adjust the Volume.....	9
6.4 Select a Preset Sound Effect	10
7. AUX / OPTICAL Operation.....	10
8. Bluetooth® Operation.....	10
9. Troubleshooting	11
10. Specifications	12

1. Important Safety Instructions

	CAUTION RISK OF ELECTRIC SHOCK DO NOT OPEN	
CAUTION: TO REDUCE THE RISK OF ELECTRIC SHOCK, DO NOT REMOVE COVER (OR BACK). NO USER-SERVICEABLE PARTS INSIDE. REFER SERVICING TO QUALIFIED SERVICE PERSONNEL.		



The lightning flash with arrowhead symbol, within an equilateral triangle, is intended to alert the user to the presence of uninsulated "dangerous voltage" within the product's enclosure that may be of sufficient magnitude as to constitute a risk of electric shock to persons.



The exclamation point within an equilateral triangle is intended to alert the user to the presence of important operating and maintenance (servicing) instructions in the literature accompanying the appliance.

1.1 Safety

- 1 Read these instructions** – All the safety and operating instructions should be read before this product is operated.
- 2 Keep these instructions** – The safety and operating instructions should be retained for future reference.
- 3 Heed all warnings** – All warnings on the appliance and in the operating instructions should be adhered to.
- 4 Follow all instructions** – All operating and usage instructions should be followed.
- 5 Do not use this apparatus near water** – The appliance should not be used near water or moisture – for example, in a wet basement or near a swimming pool and the like.
- 6 Clean only with a dry cloth.**
- 7 Do not block any ventilation openings.** Install in accordance with the manufacturer's instructions.
- 8 Do not install near any heat sources such as radiators, heaters, stoves, or other apparatus (including amplifiers) that produce heat.
- 9 Protect the power cord from being walked on or pinched particularly at plugs, convenience receptacles, and the point where they exit from the apparatus.
- 10 Only use attachments/accessories specified by the manufacturer.
- 11  Use only with the cart, stand, tripod, bracket or table specified by the manufacturer, or sold with the apparatus. When a cart or rack is used, use caution when moving the cart/apparatus combination to avoid injury from tip-over.
- 12 Unplug the apparatus during lightning storms or when unused for long periods of time.
- 13 Refer all servicing to qualified personnel. Servicing is required when the apparatus has been damaged in any way, such as power supply cord or plug is damaged, liquid has been spilled or objects have fallen into the apparatus, the unit has been exposed to rain or moisture, does not operate normally, or has been dropped.
- 14 This equipment is a Class II or double insulated electrical appliance. It has been designed in such a way that it does not require a safety connection to electrical earth.
- 15 The apparatus shall not be exposed to dripping or splashing. No objects filled with liquids, such as vases, shall be placed on the apparatus.
- 16 Minimum distance around the apparatus for sufficient ventilation is 5cm.
- 17 The ventilation should not be impeded by covering the ventilation openings with items, such as newspapers, table-cloths, curtains, etc.
- 18 No naked flame sources, such as lighted candles, should be placed on the apparatus.
- 19 Batteries should be recycled or disposed of as per state and local guidelines.
- 20 The use of apparatus in moderate or tropical climates.

Caution:

- Use of controls or adjustments or performance of procedures other than those described herein, may result in hazardous radiation exposure or other unsafe operation.

- To reduce the risk of fire or electric shock, do not expose this apparatus to rain or moisture. The apparatus must not be exposed to dripping or splashing and objects filled with liquids, such as vases, must not be placed on apparatus.
- The mains plug/appliance coupler is used as the disconnect device, the disconnect device must remain readily operable.
- Danger of explosion if battery is incorrectly replaced. Replace only with the same or equivalent type.

1.2 Warning

- The battery (batteries or battery pack) shall not be exposed to excessive heat such as sunshine, fire or the like.
- Don't disposal of a battery into fire or a hot oven, or mechanically crushing or cutting of a Battery.
- To avoid battery subjected to extremely low air pressure.
- Before operating this system, check the voltage of this system to see if it is identical to the voltage of your local power supply.
- Do not place this unit close to strong magnetic fields.
- Do not place this unit on the amplifier or receiver.
- If any solid object or liquid falls into the system, unplug the system and have it checked by qualified personnel before operating it any further.
- Do not attempt to clean the unit with chemical solvents as this may damage the finish. Use a clean, dry or slightly damp cloth.
- When removing the power plug from the wall outlet, always pull directly on the plug, never yank on the cord.
- Changes or modifications to this unit not expressly approved by the party responsible for compliance will void the user's authority to operate the equipment.
- The rating label is pasted on the bottom or back of the equipment.

Battery usage CAUTION

To prevent battery leakage which may result in bodily injury, property damage, or damage to the apparatus:

- Install all batteries correctly, + and - as marked on the apparatus.
- Do not mix old and new batteries.
- Do not mix alkaline, standard (Carbon-Zinc) or rechargeable (Ni-Cd, Ni-MH, etc.) batteries.
- Remove batteries when the unit is not used for a long time.



Correct Disposal of this product. This marking indicates that this product should not be disposed with other household wastes throughout the EU.

To prevent possible harm to the environment or human health from uncontrolled waste disposal, recycle it responsibly to promote the sustainable reuse of material resources. To return your used device, please use the return and collection systems or contact the retailer where the product was purchased. They can take this product for environmental safe recycling.



We hereby declares that this product is in compliance with the essential requirements and other relevant provisions of Directive 2014/53/EU.



The Bluetooth word mark and logos are registered trademarks owned by Bluetooth SIG, Inc. and any use of such marks by Azatom is under license. Other trademarks and trade names are those of their respective owners.

2. Package Contents



Soundbar

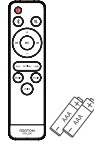

Remote Control /
AAA Batteries x 2

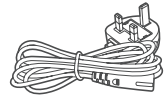

AC Power Cord *

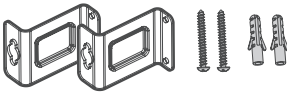

Wall mount kit
Bracket(x2) / Wall Plug(x2) /
screw(x2)



3.5mm-3.5mm audio cable

- * Power cord quantity and plug type vary by regions.
- * Images, illustrations and drawings shown on this User Manual are for reference only, actual product may vary in appearance.

Thank You for purchasing the Studio Pulse 2 for your home.

To make the most of its features, we suggest reading the instruction manual thoroughly, which includes hints and tips to assist in resolving any problems. Please go through all the safety guidelines before using it and keep this manual for future reference.

To learn more & Register for our Azatom Warranty. Please visit: www.azatom.com/warranty or scan the QR Code on the back of the Manual.

Need Help? Contact our customer service team who are always happy to help! Open 9am - 5pm Mon - Fri
Email: customersupport@azatom.com
Phone: 01740 629 901

3. Identifying the Parts

3.1 Soundbar

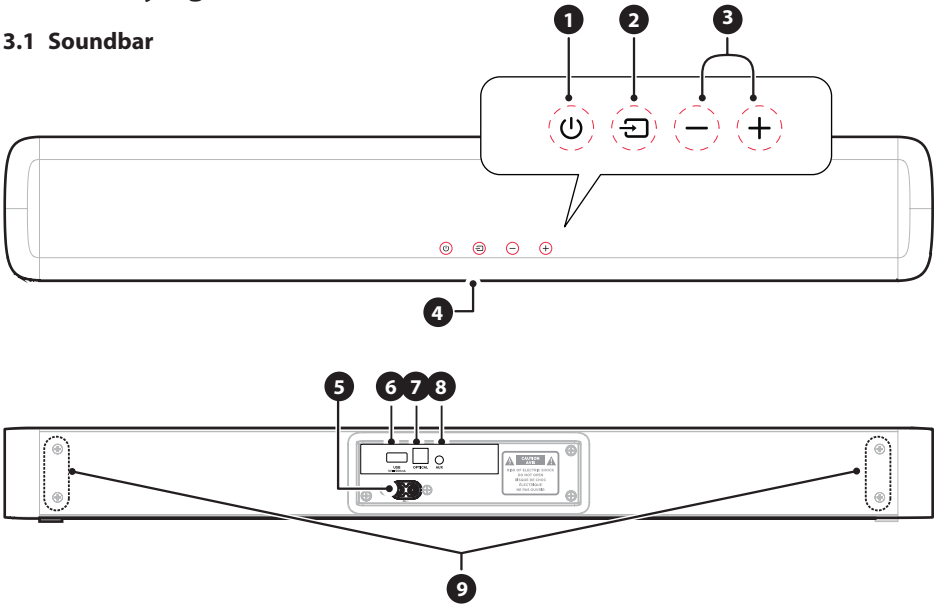

- ① **⏻ (ON/OFF) Button**
Switch the soundbar between ON and Standby mode.
- ② **↺ (SOURCE) Button**
Select the play function.
- ③ **+/- (volume) Buttons**
Increase/decrease the volume level.
- ④ **LED Indicators / Remote Control Sensor**
- ⑤ **AC~ Socket**
Connect a power cord.
- ⑥ **USB Socket**
Insert the USB device to play music.
- ⑦ **OPTICAL Socket**
Connect to an optical audio output on the TV.
- ⑧ **AUX Socket**
Connect to an external audio device.
- ⑨ **Screws**
Remove the screws then install the wall mounting screws into the back of the unit.

LED	Mode
• Red	Standby
• Green	AUX
• Blue	Bluetooth
• Amber	Optical
• White	USB

3.2 Remote Control

①		Switch the soundbar between ON and Standby mode.
②		Select the Bluetooth mode. Activate the pairing function in Bluetooth mode or disconnect the existing paired Bluetooth device.
③		Mute or resume the sound.
④		Increase/decrease the volume level.
⑤		Skip to previous /next track.
⑥		Play/pause/resume playback.
⑦	AUX	Select the AUX mode.
⑧	USB	Select the USB mode.
⑨	OPTICAL	Select the OPTICAL mode.
⑩	VOICE MOVIE MUSIC	Select Equalizer (EQ) Effect.

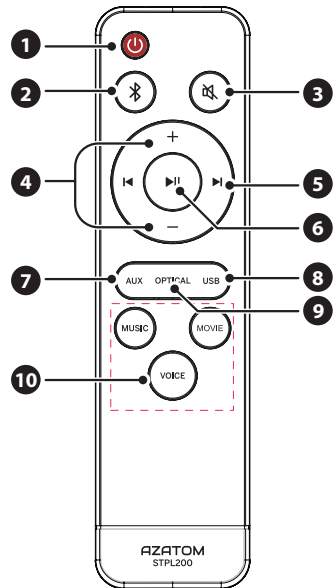

Prepare the Remote Control

The provided Remote Control allows the unit to be operated from a distance.

- Even if the Remote Control is operated within the effective range 19.7 feet (6m), remote control operation may be impossible if there are any obstacles between the unit and the remote control.
- If the Remote Control is operated near other products which generate infrared rays, or if other remote control devices using infra-red rays are used near the unit, it may operate incorrectly. Conversely, the other products may operate incorrectly.

Replace the Remote Control Battery

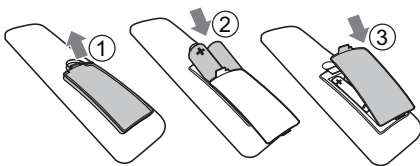

- 1 Press and slide the back cover to open the battery compartment of the remote control.
- 2 Insert two **AAA** size batteries (included). Make sure the (+) and (-) ends of the batteries match the (+) and (-) ends indicated in the battery compartment.

- 3 Close the battery compartment cover.

Precautions Concerning Batteries

- Be sure to insert the batteries with correct positive “⊕” and negative “⊖” polarities.
- Use batteries of the same type. Never use different types of batteries together.
- Either rechargeable or non-rechargeable batteries can be used. Refer to the precautions on their labels.
- Be aware of your fingernails when removing the battery cover and the battery.
- Do not drop the remote control.
- Do not allow anything to impact the remote control.
- Do not spill water or any liquid on the remote control.
- Do not place the remote control on a wet object.
- Do not place the remote control under direct sunlight or near sources of excessive heat.
- Remove the battery from the remote control when not in use for a long period of time, as corrosion or battery leakage may occur and result in physical injury, and/or property damage, and/or fire.
- Do not use any batteries other than those specified.
- Do not mix new batteries with old ones.
- Never recharge a battery unless it is confirmed to be a rechargeable type.

4. Placement and Mounting

4.1 Placement

- A If your TV is placed on a table, you can place the unit on the table directly in front of the TV stand, centered with the TV screen.
- B If your TV is attached to a wall, you can mount the unit on the wall directly below the TV screen.

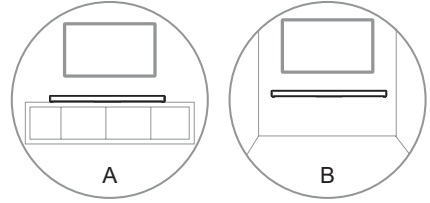

4.2 Wall Mounting

Note:

- Installation must be carried out by qualified personnel only. Incorrect assembly can result in severe personal injury and property damage (if you intend to install this product yourself, you must check for installations such as electrical wiring and plumbing that may be buried inside the wall). It is the installer's responsibility to verify that the wall will safely support the total load of the unit and wall brackets.

- Additional tools (not included) are required for the installation.
- Do not overtighten screws.
- Keep this instruction manual for future reference.
- Use an electronic stud finder to check the wall type before drilling and mounting.

WARNING

- To prevent injury, this apparatus must be securely attached to the floor/wall in accordance with the installation instructions.
- Suggested wall mounting height: ≤ 1.5 meters.

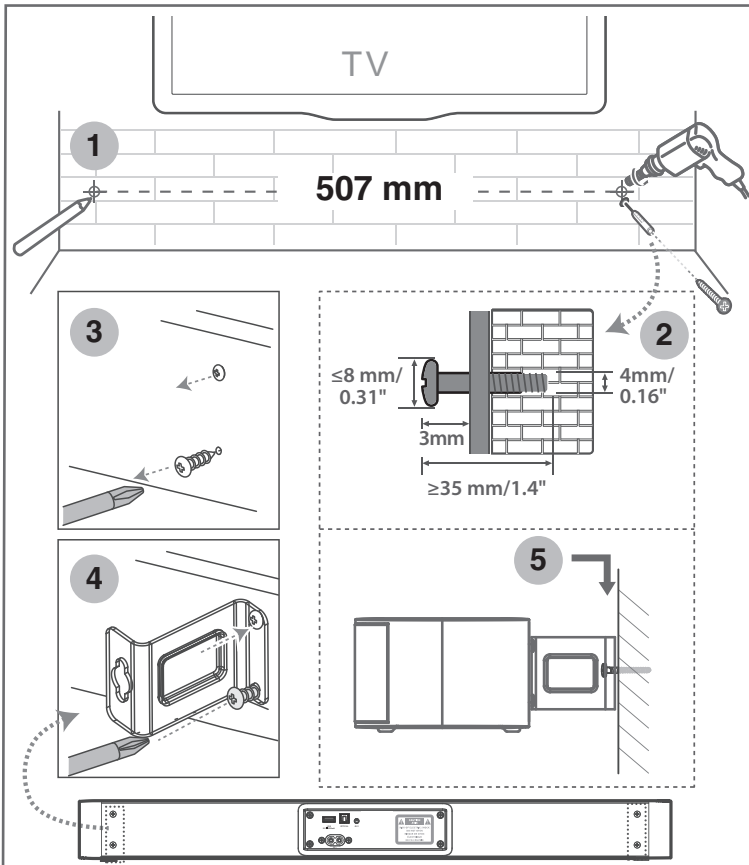

5. Connections

5.1 Use the OPTICAL Socket

- Remove the protective cap of the **OPTICAL** socket, then connect an **OPTICAL** cable to the TV's **OPTICAL OUT** socket and the **OPTICAL** socket on the Soundbar.

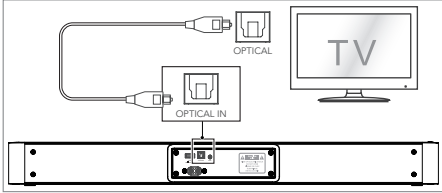

5.2 Use the AUX Socket

- A. Use a 3.5mm to 3.5mm audio cable to connect the TV's or external audio device headphone socket to the **AUX** socket on the Soundbar.

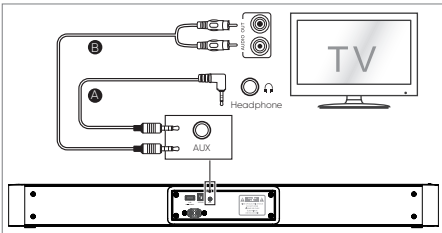

- B. Use a RCA to 3.5mm audio cable to connect the TV's audio output sockets to the **AUX** socket on the Soundbar.

5.3 Connect Power

- **Risk of product damage!** Ensure that the power supply voltage corresponds to the voltage printed on the back or the underside of the unit.
- Before connecting the AC power cord, ensure you have completed all other connections.

• **Soundbar**

Connect the mains cable to the **AC~** socket of the Soundbar and then into a mains socket.

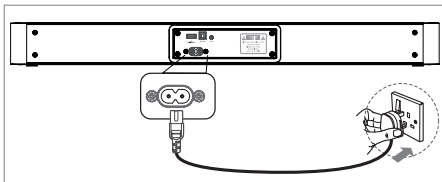

6. Basic Operation

6.1 Standby/ON

When you first connect the main unit to the mains socket, the main unit will be in Standby mode.

- Press the **⏻** button on the remote control to switch the Soundbar ON or STANDBY mode.
- Disconnect the mains plug from the mains socket if you want to switch the Soundbar OFF completely.

Auto Wake

If a TV or an external device is connected (AUX), the Soundbar will switch on automatically when the TV or the external device is switched on.

Automatic Power Off Function

The Soundbar automatically turns to **Standby** mode after about 15 minutes if the TV or the external Soundbar is disconnected, switched off.

- To switch the Soundbar off completely, remove the mains plug from the mains socket.
- Please turn the Soundbar off completely to save energy when not in use.

6.2 Select Modes

Press the **↔** (SOURCE) button repeatedly on the Soundbar or the **AUX**, **Optical**, **Bluetooth**, **USB** buttons on the remote control to select the desired mode. The indicator light on the front of the Soundbar will show which mode is currently in use.

LED	Mode
• Red	Standby
• Green	AUX
• Blue	Bluetooth
• Amber	Optical
• White	USB

6.3 Adjust the Volume

Press the **+/-** (**Volume**) on the Soundbar or on the remote control to adjust the volume.

If you wish to turn the sound off, press the **⏻** button on the remote control. Press the **⏻** button again or press the **+/-** (**Volume**) buttons to resume normal listening.

Note: While adjusting the volume, the status LED

indicator will flash quickly. When the volume has hit maximum/minimum value level, the status LED indicator will slowly flash 3 times.

6.4 Select a Preset Sound Effect

While playing, press the **VOICE / MUSIC / MOVIE** buttons on the remote control to select the preset equalizers.

The current setting of the equalizer is displayed by the operating LED.

EQ mode	LED
VOICE	●●●○○
MUSIC	○○●●●○
MOVIE	○○○●●●

7. AUX / OPTICAL Operation

- 1 Ensure that the Soundbar is connected to the TV or audio device.
- 2 Press the **SOURCE** button repeatedly on the Soundbar or the **AUX, Optical** buttons on the remote control to select the **AUX** or **Optical** mode.
- 3 Operate your audio device directly for playback features.
- 4 Press the **+/- (Volume)** button to adjust the volume to your desired level.

8. Bluetooth® Operation

Through Bluetooth, connect the Soundbar with your Bluetooth device (such as an iPad, iPhone, iPod touch, Android phone, or laptop), and then you can listen to the audio files stored on the device through your Soundbar speakers.

First time pairing

- 1 Press the **SOURCE** button on the Soundbar or press the **Bluetooth** button on the remote control to select Bluetooth® mode. The Blue indicator will flash slowly.
- 2 On the Bluetooth device, switch on Bluetooth, search for and select "**Azatom STPL200**" to start connection.
- 3 After audio prompt, the system is successfully connected and the Blue indicator will light up solidly.
- 4 Select and play audio files or music on your Bluetooth device.

- If you want to connect your Soundbar with another Bluetooth device, press and hold **Bluetooth** button to disconnect from current Bluetooth connected devices and enter the Bluetooth pairing mode. You will hear audio prompt and Blue indicator will flash rapidly. Follow step 2-3 to pair your Bluetooth® device.
- If your Bluetooth device supports A2DP, play music via your device.
- If your Bluetooth device supports AVRCP, use supplied remote control to control play.

▶|| Start, pause or resume play

◀/▶ Skip to the previous or next track

Tips:

- The operational range between the Soundbar and the device is approximately 8 metres.
- Before connecting a Bluetooth® device to the Soundbar, ensure you know the device's capabilities.
- Compatibility with all Bluetooth® devices is not guaranteed.
- Any obstacle between the device and the Soundbar can reduce operational range.
- Keep this player away from other electronic devices that may cause interference.
- The player will also be disconnected when your device is moved beyond the operational range.

USB Operation

- 1 Insert the USB device.

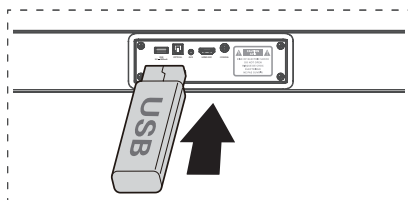

- 2 Press the **SOURCE** button on the Soundbar or on the remote control to select the USB mode.
- 3 During playback:

▶|| Start, pause or resume play

◀/▶ Skip to the previous or next track

Tips:

- This product may not be compatible with certain types of USB storage devices.
- If you use a USB extension cable, USB hub, or USB Multifunctional card reader, the USB storage device may not be recognized.

9. Troubleshooting

To keep the warranty valid, never try to repair the system yourself. If you encounter problems when using this unit, check the following points before requesting service.

Problem	Solution
No power	<ul style="list-style-type: none"> • Ensure that the AC cord of the apparatus is properly connected . • Ensure that there is power at the AC outlet. • Press \cup (standby) button to turn the Soundbar on.
Remote control does not work	<ul style="list-style-type: none"> • Before you press any playback control button, first select the correct source. • Reduce the distance between the remote control and the Soundbar. • Insert the battery with its polarities \oplus/\ominus aligned as indicated. • Replace the battery. • Aim the remote control directly at the sensor on the front of the Soundbar.
No sound	<ul style="list-style-type: none"> • Make sure that the Soundbar is not muted. Press MUTE (MUTE) or volume +/- button to resume normal listening. • Press \cup button on the Soundbar or on the remote control to switch the soundbar to standby mode. Then press the \cup button again to switch the soundbar on. • Unplug the soundbar from the mains socket, then plug them again. Switch on the soundbar. • Ensure the audio setting of the input source (e.g. TV, game console, DVD player, etc.) is set to PCM or Dolby Digital mode while using digital (e.g. OPTICAL) connection. • The Soundbar may not be able to decode all digital audio formats from the input source. In this case, the Soundbar will mute. This is NOT a defect.device is not muted. • If using Bluetooth, ensure that the volume on your source device is turned up and that the device is not muted.
I can't find the Bluetooth name of this unit on my Bluetooth device for Bluetooth pairing	<ul style="list-style-type: none"> • Ensure the Bluetooth function is activated on your Bluetooth device. • Re-pair the Soundbar with your Bluetooth device. • The Soundbar has a Bluetooth® function that can receive a signal within 8 metres. Keep a distance within 8 metres between the Soundbar and your Bluetooth® device.
The Soundbar turns off	<ul style="list-style-type: none"> • When the Soundbar's external input signal level is too low, the Soundbar will be automatically turn off after 15 minutes. Please increase the volume level of your external device.

10. Specifications

Brand	Azatom
Model	STPL200

Soundbar

Power Supply	100-240V~ 50/60Hz
Power Consumption	20 W < 0.5 W (StandBy)
USB	5V $\overline{=}$ 500mA Hi-Speed USB (2.0), FAT32 / FAT16, 32G (max), MP3
Dimension (WxHxD)	614 x 62 x 95 mm
Net weight	1.92kg
Audio input sensitivity	500mV
Frequency Response	65Hz - 20KHz

Bluetooth

Bluetooth version / profiles	V 5.3 (A2DP, AVRCP)
Bluetooth frequency range	2400 MHz ~ 2483.5 MHz
Bluetooth Max. transmitting power	\leq 5 dBm
Modulation Type	GFSK, $\pi/4$ DQPSK

Amplifier (RMS Output power)

Total	120 W Maximum/Peak/Reference/Music Power (approx.) 60 W (RMS Power @ 1% THD (W))
Soundbar	30W (8 Ω) + 30W (8 Ω)

Remote Control

Distance/Angle	19.7 feet (6m) / 30°
Battery type	AAA (1.5V x 2)

- Design and specifications are subject to change without notice.



@AZATOM

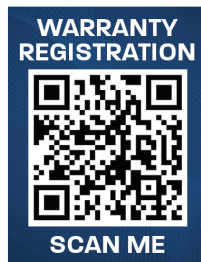

THIS MANUAL IS AVAILABLE TO DOWNLOAD ONLINE AT WWW.AZATOM.COM

AZATOM 2020 ALLRIGHTS RESERVED. AZATOM IS PART OF AZATOM GROUP LIMITED. SEE SITE FOR SAFETYINFORMATION. AZATOM RESERVE THE RIGHT TO WITHDRAW ANY AND ALL PROMOTIONS WITHOUT NOTICE. FOR FULL WARRANTY, EXTENDED WARRANTY AND PROMOTIONAL OFFER TERMS & CONDITIONS PLEASE VISIT WWW.AZATOM.COM/TERMS-CONDITIONS.

AZATOM GROUP LIMITED, TEES VALLEY COURT, WYNYARD BUISNESS PARK, BILLINGHAM,
TS22 5FE. UNITED KINGDOM